

Deck Mounted Kitchen/Shower Sprays

Product shown will vary depending on model

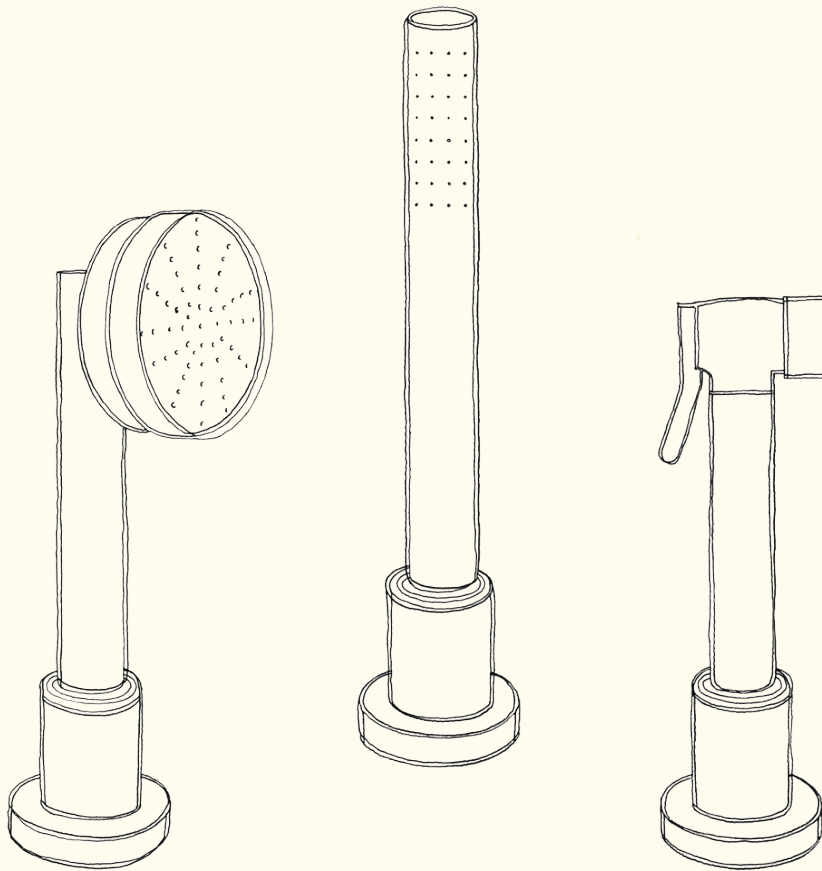

Important information:

To ensure this product is installed properly you must read and follow these guidelines.

The owner/user of this product must keep this information for future reference.

This product must be installed by a professional licensed contractor.

Only use a strap wrench or protected smooth jaw on any finished surface.

ORE

MADE IN ENGLAND

Guarantee and Aftercare

When installing or using tools, extra care must be taken to avoid damaging the finish or fitting. To maintain the appearance, please ensure it is cleaned regularly using a clean soft damp cloth only. Abrasive cleaners or detergents must not be used as they may cause surface deterioration. The company provides a guarantee against faulty material or manufacture excluding serviceable parts, providing they have been installed, cared for and used in accordance with our instructions.

More information on our Warranty and Aftercare can be found on our website.

Earth Bonding

Earth any new pipe satisfactorily (seek expert advice if in doubt).

The company reserves the right to continually evolve its product lines without notification.

The company will not accept any liability regarding specification changes and their consequences unless previously quoted by the company in writing.

Installation Procedure

1. Prior to installation please ensure that all supply pipes have been flushed through to remove any debris and then ensure the water supply is turned off.
2. We strongly recommend the fitting of isolation valves to the inlet feeds for ease of future maintenance.
3. Place the Cylinder and Thread along with the Ring and Washer through the hole cut on the counter top/bath.
4. Secure from underneath with the Retaining Nut.
5. Attach the Hose to the Handshower/spray ensuring all Washers are in place.
6. Feed through the Deck-mounted Holder from above. This Handshower/spray will seat in place on the Holder.
7. Connect the water supply to the Hose ensuring the Washer is in place.
8. Turn on the water supply and check all water feed connections to ensure that there are no leaks.
9. Check the assembled fit of the products to the sanitary ware/bath to ensure there is no water ingress that may cause water damage after installation.

71. Hand Shower; Rose

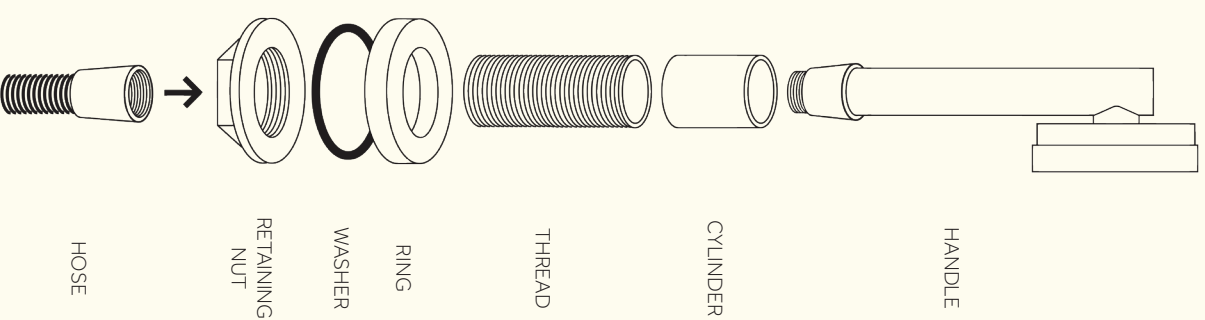

72. Hand Shower

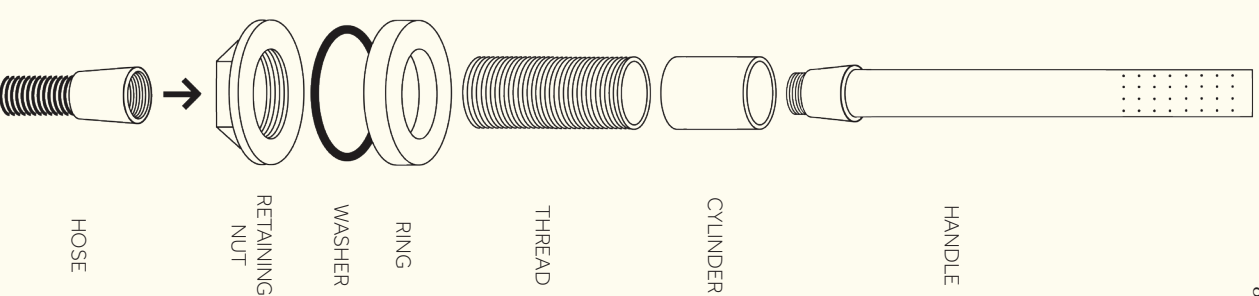

85. Kitchen Handspray

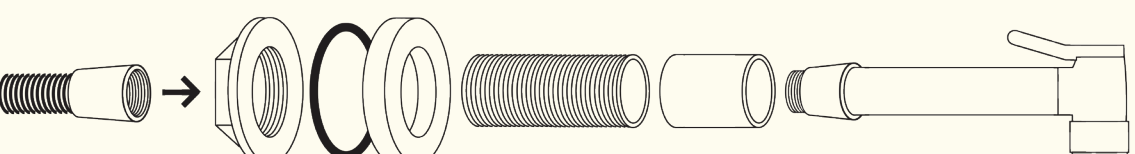

INSTALLER DETAILS:

ORE

MADE IN ENGLAND